

Electric Cord and Cable Reels
Featuring New
Commercial Cord Reels

HUBBELL



Wiring Device-Kellems

Hubbell Electric Cord and Cable Reels

Hubbell Wiring Device - Kellems now offers a complete line of electric cord, cable and static discharge reels for commercial, industrial and weatherproof applications. Hubbell reels eliminate unmanaged cords and cables which cause trip hazards or electric shock due to damaged wire insulation. These reels provide safe and

effective wire management for your facility or plant floor.

For **Safety, Durability and Performance** look to the industry **Leader... look to Hubbell.**

Weatherproof Cable Reels are made for the most abusive and demanding environments. These reels feature a solid steel construction, a 600V rating with SOW - A type cable and Type 4X enclosure rating. They are designed for use with 15 & 20 amp industrial products such as portable outlet boxes, Insulgrip® and Twist-Lock® devices and pendant push-button stations.



Industrial Cord Reels are built to provide safe, convenient power and lighting for demanding industrial applications and environments. The industrial reels are all steel construction, have a 300V rating with SJ type cord and can be ceiling, wall or bench mounted. They are available with fluorescent or incandescent hand lamps as well as a HBL5269C connector body and portable outlet box versions.



Commercial Cord Reels are designed for the less demanding requirements of commercial and light industrial environments. The Commercial reels feature steel construction and have a 125V rating with SJT type cord. These reels are UL Listed and provide power and lighting for all your needs.



Static Discharge Reels ground portable equipment operating in hazardous environments. When properly clamped to ground, the static discharge reel will prevent the build up of static electricity and reduce the chance of sparking which could cause an explosion.

Hubbell has developed a broad product line of cord reels to offer safe and efficient wire management solutions for all applications. Whatever your requirements, **Hubbell has the "reel" safety story.**



Weatherproof Cable Reels

Features

- Solid steel construction
- UL Type 4X enclosure rating
- Polyester baked on powder coat finish
- Ratchet lock
- Multi position roller guide
- Pivot base

Benefits

- Superior design for the most demanding environments.
- Watertight enclosure protects spring motor, junction box, slip ring assembly and cable entrance from hose-down and corrosion.
- Baked on finish provides tightly bonded shield to protect reel from abrasion or corrosion.
- Can be disengaged in field for constant tension applications, built in product flexibility.
- Adjustable guide with nylon rollers may be mounted in four different positions.
- Allows 340° rotation of reel. Increases range of cable to nearly any direction.

Industrial Cord Reels

Features

- Steel construction with yellow powder coat finish
- Multi-position guide arm
- Multi directional nylon rollers on guide arm
- 12 AWG 3 cond. cord standard on power reels
- Positive-latch mechanism
- Plug in power cord

Benefits

- Durable design and corrosion resistant.
- Mounting on the ceiling, wall, floor or bench.
- Easier pull and prolonged cord life.
- Greater current carrying capacity.
- Automatically maintains desired cord length.
- Requires no electrical wiring.

Commercial Cord Reels

Features

- Steel Construction
- Automatic shut off switch
- Molded on plug for power cord
- Compact size/flexible mounting
- Automatic ratchet lock

Benefits

- Durable design for commercial and general purpose applications.
- Available on fluorescent & incandescent versions. The automatic switch turns off power to the electrical attachment when the cord is fully retracted.
- Requires no electrical wiring.
- Takes up little room and can be ceiling, wall or bench mounted.
- Holds cord at desired length and provides easy, smooth retraction of cord.

Static Discharge Reels

Features

- Steel construction
- Compact design
- Massive grounding jaw clamp

Benefits

- High quality durable design.
- Takes up little space.
- Provides secure low resistance ground termination.

Ordering Information - Weatherproof Cable & Static Discharge Reels

Description	Catalog Number	Cable Type	Cable Length		Cable Gauge	Number of Conductors	Volts	Amps	Weight	
			ft.	m					lbs.	kg.
14" Weatherproof Reel	HBL501431W†	SOW-A	50	15.2	14	3	600	15	55	24
16" Weatherproof Reel	HBL501232W†	SOW-A	50	15.2	12	3	600	20	86	38.7
16" Weatherproof Reel	HBL501242W†	SOW-A	50	15.2	12	4	600	16	86	38.7
16" Weatherproof Reel	HBL501032W†	SOW-A	50	15.2	10	3	600	25	86	38.7
16" Weatherproof Reel	HBL501042W†	SOW-A	50	15.2	10	4	600	20	92	41.1
Static Discharge Reel	HBL50SD	Steel	50	15.2	3/32 O.D.	1	-	-	12	5.4
Static Discharge Reel	HBL50YSD	Steel	50 [◇]	15.2	3/32 O.D.	1 (Dual "Y")	-	-	13	5.9
14" Pivot Base	HBL14PB	-	-	-	-	-	-	-	5	2.27
16" Pivot Base	HBL16PB	-	-	-	-	-	-	-	13	5.9

* Refer to static reels ◇ (35ft./10.6m + Dual 15ft./4.5m for "Y") † All weatherproof cable reels are available with wire leads.

Specification Data

Weatherproof Reel

INCH(MM)	A	B	C	D	E	F	G	H	I	J
14" Reel	6.50 (165)	8.12 (206)	16.25 (413)	13.75 (349)	3.00 (76)	12.19 (310)	3.00 (76)	3.00 (76)	3.00 (76)	6.50 (165)
16" Reel	6.50 (165)	9.12 (232)	18.25 (464)	17.00 (432)	3.00 (76)	14.19 (360)	6.00 (152)	6.00 (152)	3.00 (76)	6.50 (165)

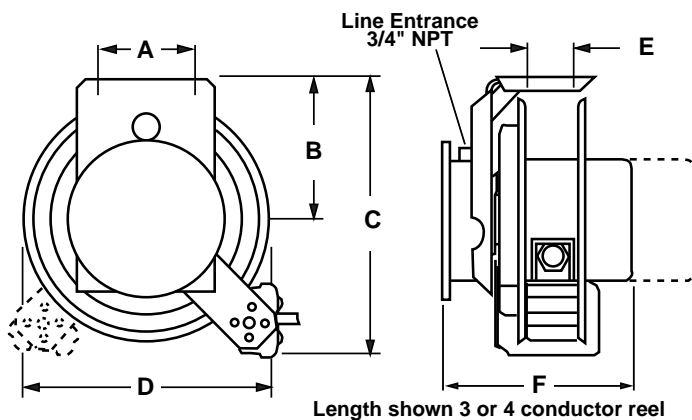

Weatherproof Cable Reel

Listings/Certifications

UL 355 and CSA 22.2 No. 21-M90
Type 4X enclosure
CAN/CSA - C22.2 No. 21-M-90

Operation

Damp, dry, indoor non hazardous location.

Classification

Agriculture, automotive, commercial and industrial applications.

Static Discharge Reel

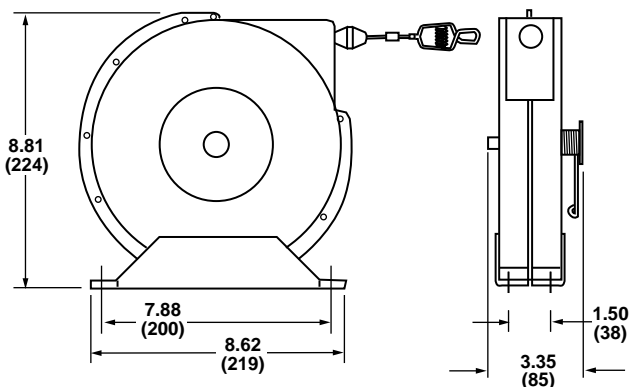

340° Pivot Base (Optional)

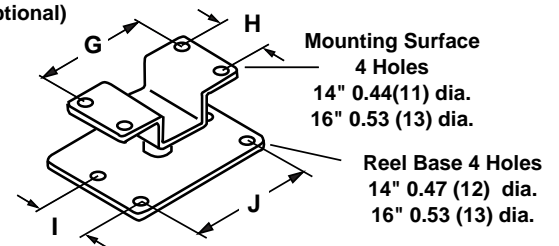

Pivot base for use only with Weatherproof Cable Reel

Ordering Information - Industrial Cord Reels

Description	Catalog Number	Cord Type	Cord Length		Cord Gauge	Number of Conductors	Volts	Amps	Weight	
			ft.	m					lbs.	kg.
Reel with HBL5269C connector	HBL45123C	SJEO	45	13.7	12	3	125	15	26	11.8
Reel with portable outlet box*	HBL45123R	SJEO	45	13.7	12	3	125	15	27	12.3
Reel with incandescent hand lamp	HBL50163IN	SJT	50	15.2	16	3	125	15	25	11.3
Reel with fluorescent hand lamp	HBL50162FL	SJT	50	15.2	16	2	120AC	13	24	10.9

*Available in 4Q97

Specification Data

Listings/Certifications

UL 355/CSA C22.2 No. 21-M90

Operation

Dry, indoor, non hazardous locations

Classification

Commercial/Industrial

Incandescent lamp

100 watt max., switch, no receptacle

Fluorescent lamp

13 watt only

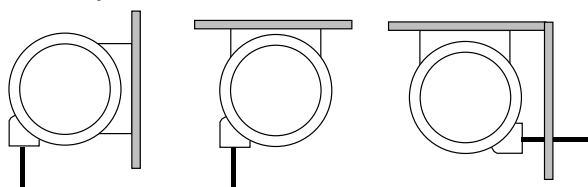

Wall mount

Ceiling mount

Bench mount

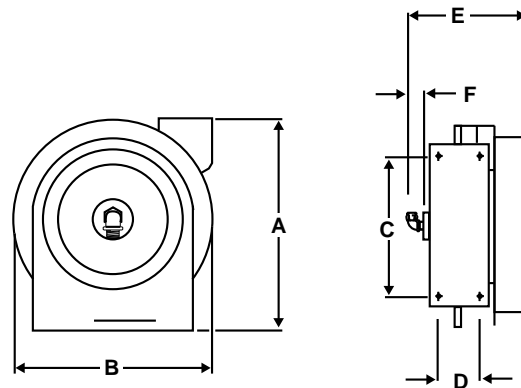

IN(MM)

A	B	C	D	E	F
13.25	12.38	8	2.5	9.38	1.25
(337)	(321)	(203)	(64)	(238)	(32)

Ordering Information - Commercial Cord Reels

Description	Catalog Number	Cord Type	Cord Length		Cord Gauge	Number of Conductors	Volts	Amps	Weight	
			ft.	m					lbs.	kg.
Reel w/fluorescent hand lamp & inline receptacle	HBLC25163FL	SJT	25	7.62	16	3	120 VAC	10	9	4.1
Reel w/fluorescent hand lamp & automatic shut off switch	HBLC25162AFL	SJT	25	7.62	16	2	120 VAC	0.3	8.2	3.7
Reel with non metallic incandescent hand lamp & automatic shut off switch	HBLC25163AIN	SJT	25	7.62	16	3	125	10	9	4.1
Reel with metallic incandescent hand lamp with receptacle & circuit breaker	HBLC25143IN	SJT	25	7.62	14	3	125	13	9.5	4.3
Reel with wire leads	HBLC25163	SJT	25	7.62	16	3	125	10	8.5	3.9
Reel with HBL5969VBK connector	HBLC25163C	SJT	25	7.62	16	3	125	10	8.5	3.9

Specification Data

Listings/Certifications

UL 355

Operation

Dry, indoor, non hazardous locations

Classification

Commercial/Industrial

Incandescent lamp

75 watt max., auto switch, no receptacle
100 watt max., with receptacle

Fluorescent lamp

13 watt with in-line receptacle
13 watt without receptacle

Dimensions in(mm)

A	11.38	(289)
B	9.50	(241)
C	2.83	(72)
D	4.11	(104)

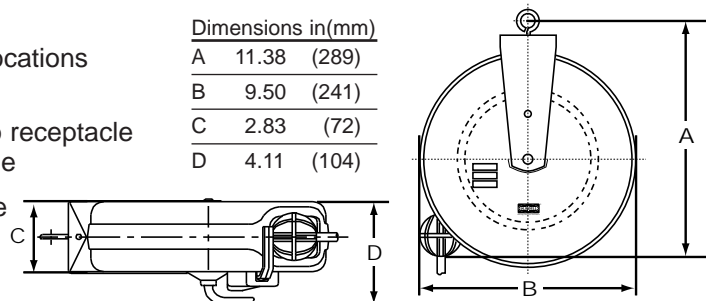

Accessories

Portable Outlet Box

Description	Catalog Number
Box with cord strain relief; with one blank coverplate	HBLPOB1
Box with cord strain relief; with two duplex (indoor) cover plates	HBLPOB1D
Blank nonmetallic FS cover plate; with foam gasket; gray	HBLP14FS
Duplex nonmetallic FS cover plate; gray	HBLP8FS
Single receptacle (1.39") nonmetallic FS cover plate; gray	HBLP7FS
Single receptacle (1.56") nonmetallic FS cover plate; gray	HBLP720FS
Rectangular opening nonmetallic FS cover plate; gray	HBLP26FS



Other Hubbell cover plates and devices which may be used with Portable Outlet Box

Duplex cover plate; weatherproof	5221, 52CM21
Single receptacle cover plate; weatherproof, 1.39"	7423W0, 74CM23W0
Single receptacle cover plate; weatherproof; 1.56"	7425WOA, 74CM25WOA
Safety-Shroud Twist-Lock® surface receptacles	HBL2310SR series, HBL2410SR series, HBL2610SR series, HBL2710SR series

Twist-Lock® Devices

2 Pole, 3 Wire Grounding 20 Ampere, 125, 250 Volts and 277 Volts AC Connector Bodies



NEMA L5-20R
20A 125V
UL/CSA
1 HP



NEMA L6-20R
20A 250V
UL/CSA
2 HP



NEMA L7-20R
20A 277V AC
UL/CSA
2 HP



Insulgrip Connector Bodies IP20 SUITABILITY

Description	Catalog Numbers		
Black and white nylon.	2313	2323	2333
Black and white nylon.	2313CN*	2323CN*	—
Corrosion resistant, yellow nylon.	23CM13	23CM23	—

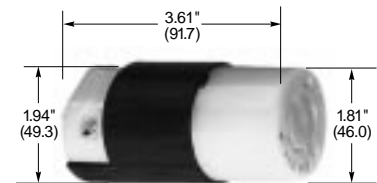

2313

Watertight Safety-Shroud Connector Bodies IP66 SUITABILITY

Description	Catalog Numbers		
Black Valox housing, White Valox clamps	HBL2313SW	HBL2323SW	HBL2333SW



NEMA L8-20R
20A 480V AC
UL/CSA
5 HP



NEMA L9-20R
20A 600V AC
UL/CSA



HBL2323SW

Insulgrip Connector Bodies IP20 SUITABILITY

Description	Catalog Numbers	
Black and white nylon.	2343	2353
Black and white nylon.	2343CN*	2353CN*



NEMA L14-20R
20A 125/250V
UL/CSA
2 (1) HP



NEMA L15-20R
20A 3Ø 250V AC
UL/CSA
3 HP



NEMA L16-20R
20A 3Ø 480V AC
UL/CSA
5 HP

Insulgrip Connector Bodies IP20 SUITABILITY

Description	Catalog Numbers		
Black and white nylon.	2413	2423	2433
Black and white nylon.	2413CN*	2423CN*	2433CN*

Note: Catalog numbers listed above with suffix CN have combination Robertson/slotted head terminal and assembly screws.



® Wiring Device - Kellems

Hubbell Incorporated (Delaware) • 185 Plains Road • Milford, CT 06460-2420 • (203) 882-4800 • FAX (800) 255-1031
World Wide Web URL: <http://www.hubbell-wiring.com>

Worldwide Locations

Hubbell Canada (905) 839-1138, Fax (905) 839-9108
Hubbell Ltd. England (441) 234-855444, Fax (441) 234-854008
Hubbell-Taian Co., Ltd., (886) 2 567-5995, Fax (886) 2 567-4853
Hubbell Int'l. Inc., Korea Branch (82) 2 607-1362, Fax (82) 2 603-7386

Hubbell de Mexico, S.A. de C.V. (52) 5 575-2022, Fax (52) 5 559-8626
Caribe Sales Agencies, Puerto Rico (809) 720-7185, Fax (809) 789-2796
Hubbell S.E. Asia Pte., Ltd., (65) 382-1600, Fax (65) 382-3727
Hubbell Inc. Middle East (971) 4 369-763, Fax (971) 4 360-541